

Smart Positioner YT-3300 / YT-3350

| Model | Motion Type | Acting Type | Explosion Protection | Lever Type | | Conduit - Air Connection*2 | Communication | Option | Operating Temp |
|---------|-------------|-------------|--|--|---|--|---------------|---|----------------|
| | | | | Linear*1 | Rotary | | | | |
| YT-3300 | L Linear | S Single | N Non-Explosion | 0 10~40mm | 1 M6 × 34L | 1 G1/2 - PT1/4 | 0 NONE | 0 NONE | S -30°C ~ 85°C |
| YT-3350 | R Rotary | D Double | I ATEX, IECEx, NEPSI, KCs A CSA, FM | 1 20~100mm 2 90~150mm 3 16~30mm 4 16~60mm 5 16~100mm 6 90~150mm | 2 M6 × 63L 3 M8 × 34L 4 M8 × 63L 5 NAMUR | 2 G1/2 - NPT1/4 3 G1/2 - G1/4 4 M20 - NPT1/4 *3 5 NPT1/2 - NPT1/4 | 2 + HART | 1 + PTM 2 + L/S(Mechanical Type) 3 + L/S(Proximity Type) 4 + PTM+L/S(Mechanical Type) 5 + PTM+L/S(Proximity Type) | L -40°C ~ 85°C |

*1 Lever 3~6 is adapter lever type.

*2 YT-3350 is available for No.2 ONLY.

*3 M20 adapter is attached to conduit entry



SIL2 / SIL3



YT-3300



YT-3300+L/S



YT-3350

| Item - Type | YT-3300 | YT-3350 |
|----------------------------------|---|---------------------------|
| Input Signal | 4~20mA DC | |
| Supply Pressure | 0.14~0.7MPa(1.4~7 bar) | |
| Stroke | Linear Type | 10~150mm |
| | Rotary Type | 0 ~ 90° |
| Impedance | Max.500Ω @ 20mA DC | |
| Air Connection | PT(NPT,G)1/4 | NPT 1/4 |
| Gauge Connection | PT(NPT)1/8 | NPT 1/8 |
| Conduit | G(PF,NPT)1/2,M20 | G(PF)1/2 |
| Operating Temp | Standard Type. | -30°C ~ 85°C (-22~185° F) |
| | Low Temp. Type. | -40°C ~ 85°C (-40~185° F) |
| LCD Operating Temp. | -30°C ~ 85°C (-22~185° F) | |
| Ambient Temp. of Explosion Proof | -40~60°C(T5) / -40~40°C(T6) | |
| Linearity | ±0.5% F.S. | |
| Hysteresis | ±0.5% F.S. | |
| Sensitivity | ±0.2% F.S. | |
| Repeatability | ±0.3% F.S. | |
| Air Consumption | Below 2LPM (sup=0.14MPa) | |
| Flow Capacity | 70LPM (sup=0.14MPa) | |
| Output Characteristics | Linear, EQ%, Quick Open user set (16 Point) | |
| Material | Aluminum Diecasting | Stainless Steel 316 |
| | Ingress Protection IP66 | |
| Explosion Protection Type | ATEX, IECEx Ex ia IIC T5/T6 Gb, Ex iaD IIIC T100°C/T85°C Db IP66 NEPSI Ex ia IIC T5/ T6 KCs Ex ia IIC T5/T6, Ex iaD IIIC T100°C/T85°C CSA Pending FM Class I, Div 1, Groups ABCD Class I, Zone 0 AEx ia IIC Class III, Div 1, Groups EFG Class I, II, III, Div 2, Groups ABCDEFG NEMA Type 4 IP66 AMBIENT TEMP: -40°C ~ 60°C (T5) / -40°C ~ 40°C (T6) | |
| Communication(Optional) | HART(ver.7) | |
| L/S | Mechanical Type(Omron) | AC 125V, 3A DC 30V, 2A |
| Rating | Proximity Type(P&F) | DC 8.2V 8.2mA |
| Weight | | 2kg(4.4lb) |
| | | 5.1kg(11.2lb) |

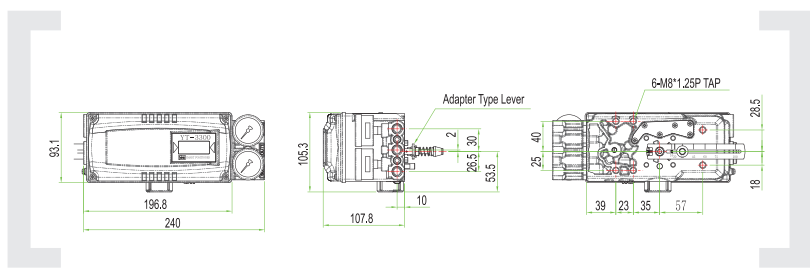

YT-3300 Smart Valve Positioner accurately controls valve stroke, according to input signal of 4-20mA being delivered from controller.

- Auto calibration
- LCD display
- Feedback signal
- Auto/Manual switch
- PID control
- Limit switch
- HART communication
- 4 buttons for local control

Smart Positioner YT-3303

| Model | Motion Type | Acting Type | Explosion Protection | Lever Type | | Conduit - Air Connection | Communication | Option | Operating Temp |
|---------|-----------------|-----------------|----------------------------------|--------------------|-------------------|-----------------------------|-----------------|----------------|-----------------------|
| | | | | Linear | Rotary | | | | |
| YT-3303 | L Linear | S Single | N Non-Explosion | 1 10~40mm | 1 M6 × 34L | 1 G1/2 - PT1/4 | 0 NONE | 0 NONE | S -30°C ~ 85°C |
| | R Rotary | D Double | I ATEX, IECEx, NEPSI, KCs | 2 20~70mm | 2 M6 × 63L | 2 G1/2 - NPT1/4 | 2 + HART | 1 + PTM | L -40°C ~ 85°C |
| | | | A CSA, FM | 3 50~100mm | 3 M8 × 34L | 3 G1/2 - G1/4 | | | |
| | | | | 4 100~150mm | 4 M8 × 63L | 4 M20 - NPT1/4 *1 | | | |
| | | | | | 5 NAMUR | 5 NPT1/2 - NPT1/4 *2 | | | |

*1 M20 adapter is attached to conduit entry
 *2 NPT 1/2 adapter is attached to conduit entry.



YT-3303

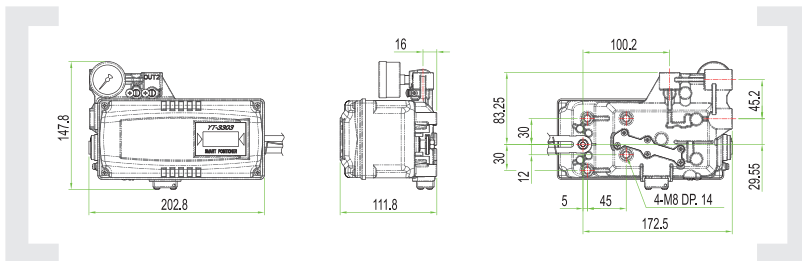

| Item · Type | YT-3303 | |
|----------------------------------|---|---------------------------|
| Input Signal | 4~20mA DC | |
| Supply Pressure | 0.14~0.7MPa(1.4~7 bar) | |
| Stroke | Linear Type | 10~150mm |
| | Rotary Type | 0 ~ 90° |
| Impedance | Max.500Ω @ 20mA DC | |
| Air Connection | PT(NPT,G)1/4 | |
| Gauge Connection | PT(NPT)1/8 | |
| Conduit | G(PF,NPT)1/2, M20 | |
| Operating Temp | Standard Type. | -30°C ~ 85°C (-22~185° F) |
| | Low Temp.Type. | -40°C ~ 85°C (-40~185° F) |
| LCD Operating Temp. | -30°C ~ 85°C (-22~185° F) | |
| Ambient Temp. of Explosion Proof | -40~60°C(T5) / -40~40°C(T6) | |
| Linearity | ±0.5% F.S. | |
| Hysteresis | ±0.5% F.S. | |
| Sensitivity | ±0.2% F.S. | |
| Repeatability | ±0.3% F.S. | |
| Air Consumption | Below 2LPM (sup=0.14MPa) | |
| Flow Capacity | 70LPM (sup=0.14MPa) | |
| Output Characteristics | Linear, EQ%, Quick Open user set (16 Point) | |
| Material | Aluminum Diecasting | |
| Ingress Protection | IP66 | |
| Explosion Protection Type | ATEX, IECEx Ex ia IIC T5/T6 Gb, Ex iaD IIIC T100°C/T85°C Db IP66 NEPSI Ex ia IIC T5/ T6 KCs Ex ia IIC T5/T6 Gb, Ex iaD IIIC T100°C/T85°C Db CSA Pending FM Class I, Div 1, Groups ABCD Class I, Zone 0 AEx ia IIC Class III, Div 1, Groups EFG Class I, II, III, Div 2, Groups ABCDEFG NEMA Type 4 IP66 AMBIENT TEMP: -40°C ~ 60°C (T5) / -40°C ~ 40°C (T6) | |
| Communication(Optional) | HART(ver.7) | |
| Weight | 2kg (4.4lb) | |

YT-3303 Smart Valve Positioner accurately controls valve stroke, according to input signal of 4-20mA being delivered from controller.

- Auto calibration
- LCD display
- Feedback signal
- Auto/Manual switch
- PID control
- HART communication
- 4 buttons for local control

Smart Positioner YT-3301

| Model | Motion Type | Acting Type | Explosion Protection | Lever Type | | Conduit - Air Connection | Communication | Option | Operating Temp | Cable Length |
|---------|-----------------|-----------------|----------------------------------|--------------------|----------------|--------------------------|-----------------|----------------|-----------------------|--------------|
| | | | | Linear | Rotary | | | | | |
| YT-3301 | L Linear | S Single | N Non-Explosion | 1 10~40mm | 5 NAMUR | 1 G1/2 - PT1/4 | 0 NONE | 0 NONE | S -30°C ~ 85°C | 1 5m |
| | R Rotary | D Double | I ATEX, IECEx, NEPSI, KCs | 2 20~70mm | | 2 G1/2 - NPT1/4 | 2 + HART | 1 + PTM | L -40°C ~ 85°C | 2 10m |
| | | | A CSA, FM | 3 50~100mm | | 3 G1/2 - G1/4 | | | | 3 15m |
| | | | | 4 100~150mm | | 4 M20 - NPT1/4 *1 | | | | 4 20m |
| | | | | | | 5 NPT1/2 - NPT1/4 | | | | |

*1 M20 is adapter type



YT-3301R Sensor



YT-3301L Sensor

YT-3301 Body



SIL2 / SIL3



| Item · Type | YT-3301L | YT-3301R |
|----------------------------------|--|--------------------------------|
| Input Signal | 4~20mA DC | |
| Supply Pressure | 0.14~0.7MPa(1.4~7 bar) | |
| Stroke | 10~150mm | 0 ~ 90° |
| Impedance | Max.500Ω @ 20mA DC | |
| Air Connection | PT(NPT,G)1/4 | |
| Gauge Connection | PT(NPT)1/8 | |
| Conduit | G(PF,NPT)1/2, M20 | |
| Operating Temp | Sensor Operating Temp. | -40°C ~ 120°C(-40~248°F) |
| | Body Operating Temp. | -30°C ~ 85°C (-22~185°F) |
| LCD Operating Temp. | -30°C ~ 85°C (-22~185°F) | |
| Ambient Temp. of Explosion Proof | -40~60°C(T5) / -40~40°C(T6) | |
| Linearity | ±0.5% F.S. | |
| Hysteresis | ±0.5% F.S. | |
| Sensitivity | ±0.2% F.S. | |
| Repeatability | ±0.3% F.S. | |
| Air Consumption | Below 2LPM (sup=0.14MPa) | |
| Flow Capacity | 70LPM (sup=0.14MPa) | |
| Output Characteristics | Linear, EQ%, Quick Open user set (16 Point) | |
| Material | Aluminum Diecasting | |
| Ingress Protection | IP66 | |
| Explosion Protection Type | ATEX, IECEx Ex ia IIC T5/T6 Gb, Ex iaD IIC T100°C/T85°C Db IP66 NEPSI Ex ia IIC T5/ T6 KCs Ex ia IIC T5/T6, EX iaD IIC T100°C/T85°C CSA Pending FM Class I, Div 1, Groups ABCD Class I, Zone 0 AEx ia IIC Class II/III, Div 1, Groups EFG Class I, II, III, Div 2, Groups ABCDEFG NEMA Type 4 IP66 AMBIENT TEMP: -40°C ~ 60°C (T5) / -40°C ~ 40°C (T6) | |
| Communication(Optional) | HART(ver.7) | |
| Weight | Body | 2kg (4.4lb) |
| | Sensor | 0.6kg (1.3lb) 0.9kg (2.0lb) |

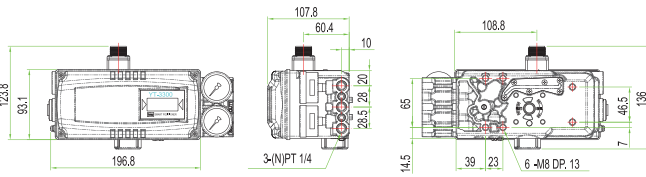

YT-3301 Body

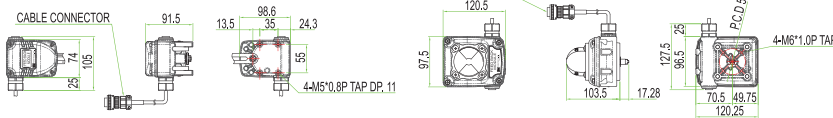

YT-3301L Sensor

YT-3301R Sensor

YT-3301 Smart Valve Positioner accurately controls valve stroke, according to input signal of 4-20mA being delivered from controller.

- Separated feedback module
- Auto calibration
- LCD display
- Auto/Manual switch
- PID control
- Feedback signal
- HART communication
- 4 buttons for local control

Smart Positioner YT-3400 / YT-3450

| Model | Motion Type | Acting Type | Explosion Protection | Lever Type | | Conduit - Air Connection *1 | Communication | Option *3 | Operating Temp |
|---------|-----------------|-----------------|----------------------------------|--------------------|--------------------------|-----------------------------|----------------|---|-----------------------|
| | | | | Linear | Rotary | | | | |
| YT-3400 | L Linear | S Single | C ATEX, IECEx, NEPSI, KCs | 1 10~40mm | 1 M6×34L | 1 G1/2 - PT1/4 | 0 NONE | 0 NONE | S -30°C ~ 85°C |
| YT-3450 | R Rotary | D Double | A CSA, FM | 2 20~70mm | 2 M6×63L | 2 G1/2 - NPT1/4 | 2 +HART | 1 +PTM 2 +L/S 3 +PTM+L/S | L -40°C ~ 85°C |
| | | | | 3 50~100mm | 3 M8×34L | 3 G1/2 - G1/4 | | | |
| | | | | 4 100~150mm | 4 M8×63L | 4 M20 - NPT1/4 *2 | | | |
| | | | | 5 NAMUR | 5 NPT1/2 - NPT1/4 | | | | |

*1 YT-3450 is available for No.2 ONLY.

*3 L/S: DC24V and Transistor Type Switch.

*2 M20 adapter is attached to conduit entry

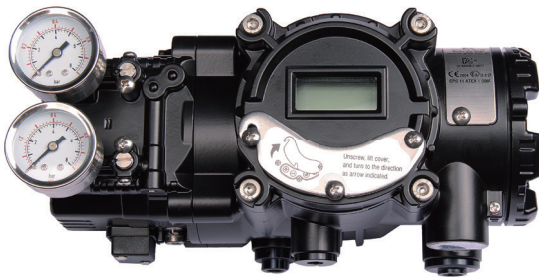

YT-3400

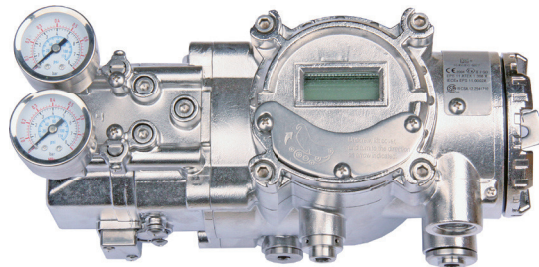

YT-3450

| Item · Type | YT-3400 | YT-3450 |
|----------------------------------|---|---------------------------|
| Input Signal | 4~20mA DC | |
| Supply Pressure | 0.14~0.7MPa(1.4~7 bar) | |
| Stroke | Linear Type | 10~150mm |
| | Rotary Type | 0 ~ 90° |
| Impedance | Max.450Ω @ 20mA DC | |
| Air Connection | PT(NPT,G)1/4 | NPT 1/4 |
| Gauge Connection | PT(NPT)1/8 | NPT 1/8 |
| Conduit | G(PF,NPT)1/2, M20 | G(PF)1/2 |
| Operating Temp | Standard Type. | -30°C ~ 85°C (-22~185° F) |
| | Low Temp Type. | -40°C ~ 85°C (-40~185° F) |
| LCD Operating Temp. | -30°C ~ 85°C (-22~185° F) | |
| Ambient Temp. of Explosion Proof | -40~80°C(T5) / -40~70°C(T6) | |
| Linearity | ±0.5% F.S. | |
| Hysteresis | ±0.5% F.S. | |
| Sensitivity | ±0.2% F.S. | |
| Repeatability | ±0.3% F.S. | |
| Air Consumption | Below 2LPM (sup=0.14MPa) | |
| Flow Capacity | 70LPM (sup=0.14MPa) | |
| Output Characteristics | Linear, EO%, Quick Open user set (16 Point) | |
| Material | Aluminum Diecasting | Stainless Steel 316 |
| Ingress protection | IP66 | |
| Explosion Protection Type | ATEX, IECEx Ex db IIC T5/T6, Ex tb IIC T85°C/T100°C NEPSI Ex db IIC T5/ T6, DIP A21 TA, T5/T6 KCs Ex d IIC T5/T6 IP66 CSA Ex db IIC T5 or T6 Class I, Zone 1, AEx db IIC T5 or T6, Class II, Division 1, Groups E, F and G; Ex tb IIC T85°C/T100°C AEx tb IIC T85°C/T100°C FM XP/II/1/ABCD/T6 Ta= -40°C to +70°C, T5 Ta= -40°C to +80°C I/1/AEx db IIC/T6 Ta= -40°C to +70°C, T5 Ta= -40°C to +80°C DIP/II, III/1/EFG/T6 Ta= -40°C to +70°C, T5 Ta= -40°C to +80°C 21/AEx tb IIC/T85°C Ta= -40°C to +70°C, T100°C Ta= -40°C to +80°C; IP66 | |
| Communication(Optional) | HART(ver.7) | |
| Weight | 3.4kg (7.5lb) | 7.0kg(15.4lb) |

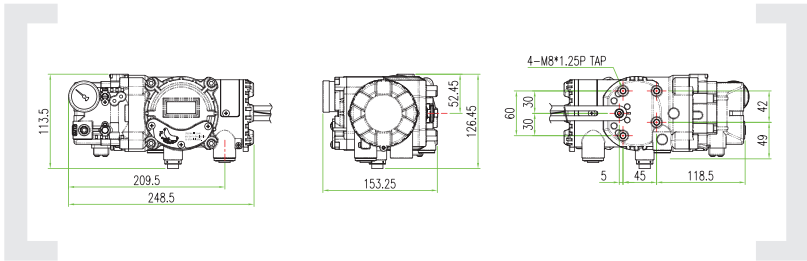

YT-3400 Smart Valve Positioner accurately controls valve stroke, according to input signal of 4-20mA being delivered from controller.

- Auto calibration
- Auto/Manual switch
- LCD display
- PID control
- Feedback signal
- Limit switche
- HART communication
- 4 buttons for local control

Smart Positioner YT-2500 / YT2550

| Model | Motion Type | Acting Type | Explosion Protection | Lever Type | | Conduit - Air Connection *1 | Communication | Option | Fail Option |
|---------|-----------------|-----------------|----------------------------------|--------------------|--------------------------|-----------------------------|-----------------|-------------------------------------|----------------------|
| | | | | Linear | Rotary | | | | |
| YT-2500 | L Linear | S Single | N Non-Explosion | 1 10~40mm | 1 M6×34L | 1 G1/2 - PT1/4 | 0 NONE | 0 NONE | F Fail Freeze |
| YT-2550 | R Rotary | D Double | I ATEX, IECEx, NEPSI, KCs | 2 20~70mm | 2 M6×63L | 2 G1/2 - NPT1/4 | 2 + HART | 1 + PTM | S Fail Safe |
| | | | | 3 50~100mm | 3 M8×34L | 3 G1/2 - G1/4 | | | |
| | | | | 4 100~150mm | 4 M8×63L | 4 M20 - NPT1/4 *2 | | | |
| | | | | 5 NAMUR | 5 NPT1/2 - NPT1/4 | 5 NPT1/2 - NPT1/4 | | | |
| | | | | | | | | 2 + L/S(Mechanical Type) | |
| | | | | | | | | 3 + L/S(Proximity Type) | |
| | | | | | | | | 4 + PTM+L/S(Mechanical Type) | |
| | | | | | | | | 5 + PTM+L/S(Proximity Type) | |

*1 YT-2550 is available for No.2 ONLY.

*2 M20 adapter is attached to conduit entry



YT-2500



YT-2550



| Item · Type | YT-2500 | YT-2550 |
|---------------------------|---|-----------------------------|
| Input Signal | 4~20mA DC | |
| Supply Pressure | 0.14~0.7MPa(1.4~7 bar) | |
| Stroke | Linear Type | 10~150mm |
| | Rotary Type | 0 ~ 90° |
| Impedance | Max.500Ω @ 20mA DC | |
| Air Connection | PT(NPT,G)1/4 | NPT 1/4 |
| Gauge Connection | PT(NPT)1/8 | NPT 1/8 |
| Conduit | G(PF,NPT)1/2, M20 | G(PF)1/2 |
| Operating Temp. | Operating Temp. | -30°C ~ 80°C (-22~176 ° F) |
| | Explosion Temp. | -40~60°C(T5) / -40~40°C(T6) |
| Linearity | ±0.5% F.S. | |
| Hysteresis | ±0.5% F.S. | |
| Sensitivity | ±0.2% F.S. | |
| Repeatability | ±0.3% F.S. | |
| Air Consumption | Fail Freeze | 0.01LPM(sup=0.14MPa) |
| | Fail Safe | 6 LPM(sup=0.14MPa) |
| Flow Capacity | Fail Freeze | 60 LPM(sup=0.14MPa) |
| | Fail Safe | 40 LPM(sup=0.14MPa) |
| Output Characteristics | Linear, EQ%, Quick Open user set (16 Point) | |
| Material | Aluminum Diecasting | Stainless steel 316 |
| Ingress Protection | IP66 | |
| Explosion Protection Type | ATEX, IECEx Ex ia IIC T5/T6 Gb, Ex iaD IIC T85°C/T100°C IP6X NEPSI Ex ia IIC T5/T6 KCs ia IIC T5/T6, EX iaD IIC T100°C/T85°C | |
| Communication(Optional) | HART(ver.5) | |
| L/S | Mechanical Type(Omron) | AC 125V, 3A DC 30V, 2A |
| Rating | Proximity Type(P&F) | DC 8.2V 8.2mA |
| Weight | 1.5kg (3.3lb) | 2.9kg (6.4lb) |

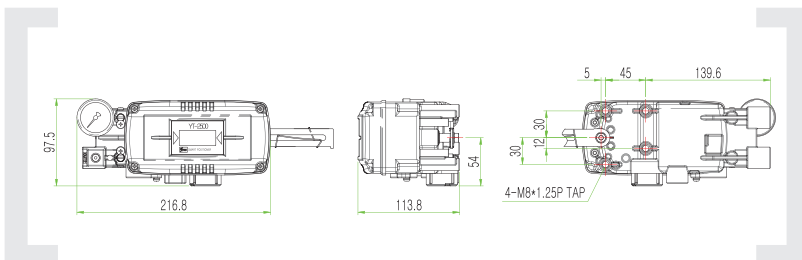

YT-2500 Smart Valve Positioner accurately controls valve stroke, according to input signal of 4-20mA being delivered from controller.

- Fail freeze function
- Auto calibration
- LCD display
- Near zero air consumption level
- PD control
- Feedback signal
- HART communication
- 4 buttons for local control
- Limit switch

Smart Positioner YT-2501

| Model | Motion Type | Acting Type | Explosion Protection | Lever Type | | Conduit - Air Connection | Communication | Option | Fail Option | Cable Length |
|---------|-----------------|-----------------|---------------------------|--------------------|----------------|--------------------------|-----------------|---------------|----------------------|--------------|
| | | | | Linear | Rotary | | | | | |
| YT-2501 | L Linear | S Single | N Non-Explosion | 1 10~40mm | 5 NAMUR | 1 G1/2 - PT1/4 | 0 NONE | 0 NONE | F Fail Freeze | 1 5m |
| | R Rotary | D Double | I ATEX, IECEx, KCs | 2 20~70mm | | 2 G1/2 - NPT1/4 | 2 + HART | 1 +PTM | S Fail Safe | 2 10m |
| | | | | 3 50~100mm | | 3 G1/2 - G1/4 | | | | 3 15m |
| | | | | 4 100~150mm | | 4 M20 - NPT1/4 *1 | | | | 4 20m |
| | | | | | | 5 NPT1/2 - NPT1/4 | | | | |

*1 M20 adapter is attached to conduit entry



YT-2501R Sensor



YT-2501L Sensor

YT-2501 Body

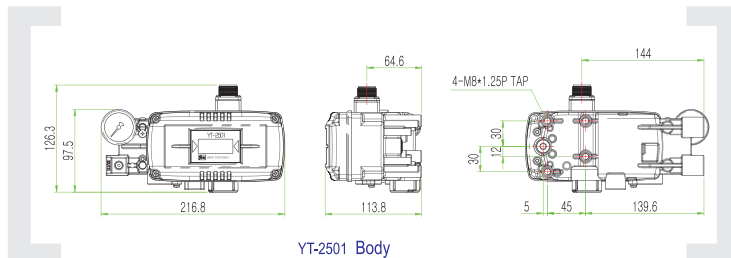

YT-2501 Body

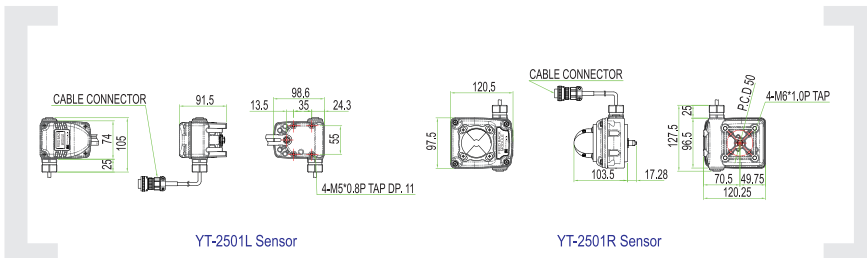

YT-2501L Sensor

YT-2501R Sensor



| Item · Type | YT-2501L | YT-2501R |
|---------------------------|---|-------------------------------|
| Input Signal | 4~20mA DC | |
| Supply Pressure | 0.14~0.7MPa(1.4~7 bar) | |
| Stroke | 10~150mm | 0 ~ 90° |
| Impedance | Max.500Ω @ 20mA DC | |
| Air Connection | PT(NPT,G)1/4 | |
| Gauge Connection | PT(NPT)1/8 | |
| Conduit | G(PF,NPT)1/2, M20 | |
| Operating Temp | Sensor Operating Temp. | -40°C ~ 120°C(-40~248°F) |
| | Body Operating Temp. | -30°C ~ 80°C(-22~176°F) |
| | Explosion Temp. | -40~60°C(T5) / -40~40°C(T6) |
| Linearity | ±0.5% F.S. | |
| Hysteresis | ±0.5% F.S. | |
| Sensitivity | ±0.2% F.S. | |
| Repeatability | ±0.3% F.S. | |
| Air | Fail Freeze | 0.01LPM (sup=0.14MPa) |
| Consumption | Fail Safe | 6 LPM (sup=0.14MPa) |
| Flow | Fail Freeze | 60 LPM (sup=0.14MPa) |
| Capacity | Fail Safe | 40 LPM (sup=0.14MPa) |
| Output Characteristics | Linear, EQ%, Quick Open user set (16 Point) | |
| Material | Aluminum Diecasting | |
| Ingress Protection | IP66 | |
| Explosion Protection Type | ATEX, IECEx Ex ia IIC T5/T6 Gb, Ex iaD IIC T85°C/T100°C IP6X KCs Ex ia IIC T5/T6, Ex iaD IIC T100°C/T85°C | |
| Communication(Optional) | HART(ver.5) | |
| Weight | Body | 1.5kg (3.3lb) |
| | Sensor | 0.6kg (1.3lb) 0.9kg (2.0lb) |

YT-2501 Smart Positioner supplies remote functions and higher liabilities in **high temperature and vibration environment.**

- Separated feedback module
- Auto calibration
- LCD display
- Near zero air consumption level
- PD control
- Feedback signal
- HART communication
- 4 buttons for local control
- Fail freeze & safe function

Smart Positioner YT-2600

| Model | Motion Type | Acting Type | Explosion Protection | Lever Type | | Conduit - Air Connection | Communication | Option *1 | Fail Option |
|---------|-------------|-------------|----------------------|-------------------|-------------------|--------------------------|---------------|-----------|---------------|
| | | | | Linear | Rotary | | | | |
| YT-2600 | L Linear | S Single | C ATEX, IECEx, KCs | 1 10~40mm | 1 M6×34L | 1 G1/2 - PT1/4 | 0 NONE | 0 NONE | F Fail Freeze |
| | | D Double | | 2 20~70mm | 2 M6×63L | 2 G1/2 - NPT1/4 | 2 +HART | 1 +PTM | S Fail Safe |
| | R Rotary | 3 50~100mm | | 3 M8×34L | 3 G1/2 - G1/4 | 2 +L/S | | | |
| | | 4 100~150mm | | 4 M8×63L | 4 M20 - NPT1/4 *1 | 3 +PTM+L/S | | | |
| | | 5 NAMUR | | 5 NPT1/2 - NPT1/4 | | | | | |

*1 M20 adapter is attached to conduit entry

*1 L/S: DC24V and Transistor Type Switch.



YT-2600

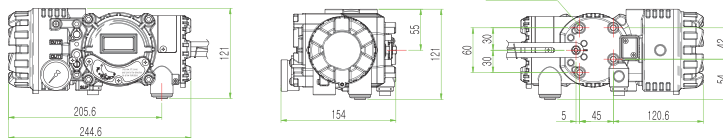

| Item · Type | YT-2600L | YT-2600R |
|---------------------------|--|-----------------------------|
| Input Signal | 4~20mA DC | |
| Supply Pressure | 0.14~0.7MPa(1.4~7 bar) | |
| Stroke | 10~150mm | 0 ~ 90° |
| Impedance | Max.460Ω @ 20mA DC | |
| Air Connection | PT(NPT,G)1/4 | |
| Gauge Connection | PT(NPT)1/8 | |
| Conduit | G(PF,NPT)1/2, M20 | |
| Operating Temp | Operating Temp. | -30°C ~ 80°C (-22~176 ° F) |
| | Explosion Temp. | -40~80°C(T5) / -40~70°C(T6) |
| Linearity | ±0.5% F.S. | |
| Hysteresis | ±0.5% F.S. | |
| Sensitivity | ±0.2% F.S. | |
| Repeatability | ±0.3% F.S. | |
| Air Consumption | Fail Freeze | 0.01LPM (sup=0.14MPa) |
| | Fail Safe | 6 LPM (sup=0.14MPa) |
| Flow Capacity | Fail Freeze | 50LPM (sup=0.14MPa) |
| | Fail Safe | 40LPM (sup=0.14MPa) |
| Output Characteristics | Linear, EQ%, Quick Open user set (16 Point) | |
| Material | Aluminum Diecasting | |
| Ingress Protection | IP66 | |
| Explosion Protection Type | ATEX, IECEx Ex db IIC T5/T6, Ex tb IIC T85°C/T100°C KCs Ex d IIC T5/T6 IP66 | |
| Communication(Optional) | HART(ver.5) | |
| Weight | 3.0kg (6.61lb) | |

YT-2600 Smart Valve Positioner accurately controls valve stroke, according to input signal of 4-20mA being delivered from controller.

- Fail freeze function
- Auto calibration
- LCD display
- Near zero air consumption level
- PD control
- Feedback signal
- HART communication
- 4 buttons for local control
- Limit switch

Smart Positioner YT-2700

| Model | Motion Type | Acting Type | Explosion Protection | Lever Type | | Conduit-Air Connection | Communication | Option | Fail Option | |
|---------|-----------------|-----------------|------------------------|-----------------|-----------------|------------------------|---------------|---------------|----------------------|----------------------|
| | | | | Linear | Rotary | | | | | |
| YT-2700 | L Linear | S Single | N Non-Explosion | 1 5~35mm | 1 M6×34L | 1 G1/2-PT1/4 | 0 NONE | 0 NONE | F Fail Freeze | |
| | R Rotary | | | | 2 M6×63L | | | | | 2 G1/2-NPT1/4 |
| | | | I KCs | | 3 M8×34L | | | | | |
| | | | | | 4 M8×63L | | | | | |
| | | | | | 5 NAMUR | | | | | |



YT-2700



compact size

| Item · Type | YT-2700L | YT-2700R |
|---------------------------|---|-----------------------------|
| Input Signal | 4~20mA DC | |
| Supply Pressure | 0.14~0.7MPa(1.4~7 bar) | |
| Stroke | 5~35mm | 0~90° |
| Impedance | Max.450Ω @ 20mA DC | |
| Air Connection | PT(NPT)1/4 | |
| Gauge Connection | PT(NPT)1/8 | |
| Conduit | G1/2 (PF1/2) | |
| Operating Temp | Operating Temp. | -30°C ~ 80°C (-22~176° F) |
| | Explosion Temp. | -40~60°C(T5) / -40~40°C(T6) |
| Linearity | ±0.5% F.S. | |
| Hysteresis | ±0.5% F.S. | |
| Sensitivity | ±0.2% F.S. | |
| Repeatability | ±0.3% F.S. | |
| Air Consumption | 0.01LPM(sup=0.14MPa) | |
| Flow Capacity | 9LPM(sup=0.14MPa) | |
| Output Characteristics | Linear, EQ%, Quick Open user set (16 Point) | |
| Material | Aluminum Diecasting | |
| Ingress Protection | IP66 | |
| Explosion Protection Type | KCs | Ex ia IIC T5 |
| Communication(Optional) | HART(ver.5) | |
| Weight | 0.82kg (1.8lb) | |

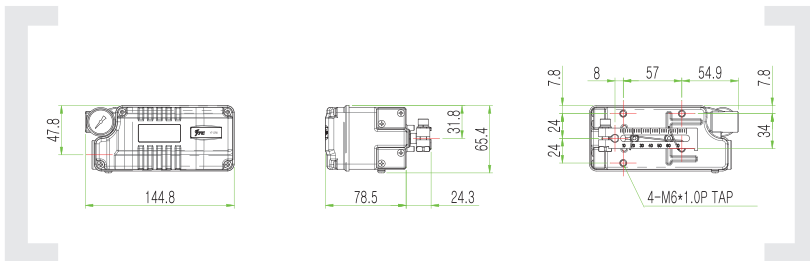

YT-2700 Compact smart valve positioner accurately controls valve stroke, according to input signal of 4-20mA being delivered from controller.

- Fail freeze function
- LCD display
- Feedback signal
- Near zero air consumption level
- PD control
- Auto calibration
- HART communication
- 4 buttons for local control
- Single acting only

Smart Positioner TMP-3000

| Model | Acting Type | Explosion Protection | Conduit-Air Connection | Flow Capacity | Option | Fail Option |
|----------|-----------------|------------------------|-------------------------|----------------|----------------|----------------------|
| TMP-3000 | S Single | N Non-Explosion | G M16X1.5 - G1/8 | 1 20LPM | 0 NONE | F Fail Freeze |
| | D Double | | | 2 50LPM | 1 + PTM | S Fail Safe |



| Item · Type | TMP-3000 |
|------------------------|--|
| Power Supply | 24VDC ± 10% |
| Input Signal | 0/4 ... 20mA, 0 ... 5/10V |
| Residual Ripple | 10%, Not industrial DC |
| Power Consumption | < 4W |
| Output | 4 ~ 20mA |
| Output Characteristics | Linear, EQ%, Quick Open user set (16 point) |
| Operating Temp | -10 ~ 60 °C |
| Supply Pressure | 0 ~ 0.7 MPa (0 ~ 7 bar) |
| Air Consumption | 0 LPM |
| Flow Capacity | 20 / 50 LPM |
| Filtering Size | 5 micron |
| Acting Type | Single 2 solenoid valves Double 4 solenoid valves |
| Stroke | 5 ~ 40mm |
| Air Connection | G1/8 (Ø6mm tube) |
| Conduit | M16x1.5 (with screw terminals) |
| Ingress Protection | IP67 |
| Body Material | PPS |
| Cover Material | PC |
| Weight | 820g (1.8lb) |

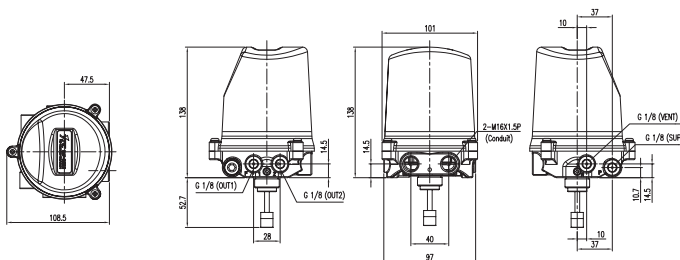

TMP-3000 valve stroke, according to input signal of 4-20mA being delivered from controller.

- Interchangeable fail action
- Feedback signal
- Auto calibration
- Near zero consumption level
- 4 buttons for local control
- LCD display with backlight
- Simple mounting